



Hanbury Range

# Widebeam Fully Fitted

## SPECIFICATION



Derby Office Mercia Marina, Findern Lane, Willington, Derbyshire DE65 6DW Tel: 01283 707357 Fax: 01283 707364  
Hanbury Office Hanbury Wharf, Hanbury Road, Droitwich, Worcester WR9 7DU Tel: 01905 794445 Fax: 01905 776750

[www.newandusedboat.co.uk](http://www.newandusedboat.co.uk)

The Hanbury Range is built by Orchard Marina and Collingwood Boats and is exclusively available through the New and Used Boat Co.

# Plans

Plans are shown for illustration purposes only and are not to scale.

Monarch 60x12ft  
£104,950 inc VAT

Emperor 60x12ft  
£104,950 inc VAT

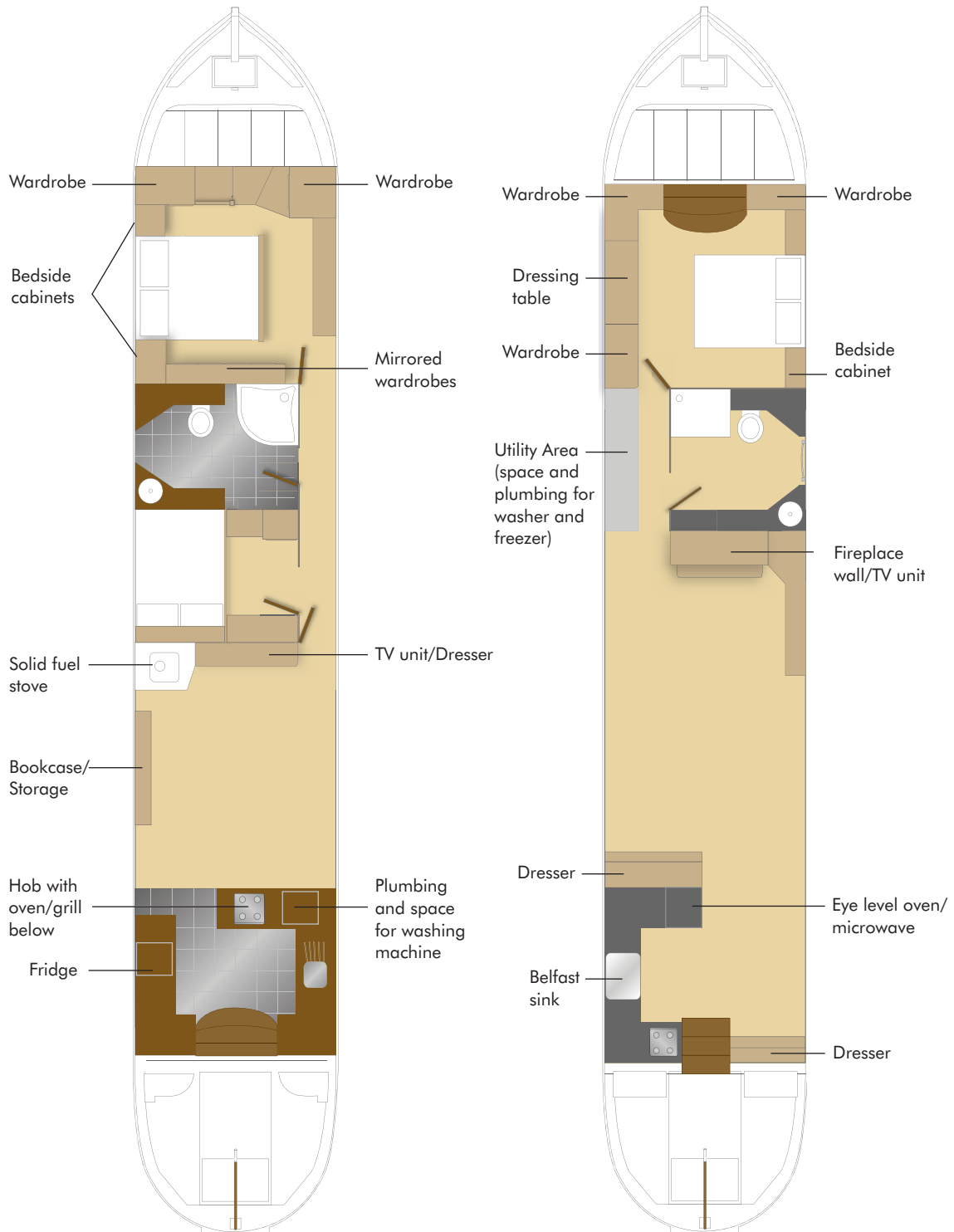

Boats are delivered to either Hanbury Wharf or Mercia Marina at a cost of £495 (to include crane and launch). Boats are delivered ready to cruise including equipment inventory. We provide a thorough handover service which will take you through all aspects of the boat and will include a familiarisation cruise. Whats more all our boats are covered by a minimum 12 month warranty with some major components such as engines covered for even longer. Please ask for details.

# Overview

The Hanbury widebeam range currently consists of two models, the Monarch and the Emperor. Both are available in conventional and reverse layout in standard lengths of 55ft, 57ft and 60ft, although alternative lengths up to 70ft are available. All models are available in a choice of widths, either 10, 11 or 12ft

- Fully lined in oak or ash veneer with oak or ash hardwood trims.
- Mix of windows and port holes in gold anodised aluminium
- High specification galley with hardwood worktops inset round stainless steel sink with monobloc stainless taps, eye level oven, four gas ring hob and built-in microwave.
- Bathroom, fitted with hand basin, toilet and large fully enclosed shower.
- Exterior paint in high quality gloss marine enamel.
- Smooth rolled style steelwork in the front bow.
- 3 rubbing strakes (*one full length*).
- Glazed hardwood bow and all steel hardwood panelled stern doors.
- The boat comes fully ballasted (*Customer to install trim ballast as needed*).

# Technical

## Steel specification

- |                     |   |
|---------------------|---|
| • Plating           | 10mm/6mm/5mm/4mm  |
| • Water Tank        | Stainless Steel 120 gallons ( <i>approx</i> )   |
| • Fuel Tank         | 60 gallons ( <i>approx</i> ) with recessed filler and drain off                         |
| • Style             | Cruiser ( <i>Trad and Semi-Trad options available</i> )                                 |
| • Decks             | All self draining   |
| • Weed Hatch        | Quick release   |
| • Fender eyes       | Recessed  |
| • Pole & Plank rack | Fitted to roof  |
| • Gas Locker        | Installed to bow or stern depending upon layout design, with space for two 13kg bottles |

## Engine

Canaline 52, 4 cylinder 2200cc engine with twin alternators - 50A and 110A, low noise Indirect Injection. PRM 150 hydraulic gearbox. Deluxe engine control panel with tachometer, water temperature, oil pressure & battery warning lights and voltage indicator. RCD emission compliant. 3 year warranty.

## Tanks

Stainless steel water tank 120 gallons (*approx*). Diesel Tank 60 gallons (*approx*). Pressure tested.

## Heating system

Diesel fired central heating system, with timer, running 3 radiators and a heated towel rail through a twin coil 13 gallon calorifier which is also connected to the engine cooling circuit meaning that the engine will heat the hot water. Additionally there is a Morso Squirrel solid fuel stove in the saloon.

# Technical (cont'd)

## **240v power system**

These craft come with a 240v system as standard, tested and installed to the relevant RCD standards. This has 3 double sockets in brushed stainless steel and simply needs plugging into the shore power. Sterling 2500w/70A pure sine wave combination Inverter/Charger.

## **12v system**

3 x 135A/h Domestic batteries which are charged by a dedicated alternator. These are connected to a purpose-built distribution panel, which carries individual breakers for all of the appliances. The lighting is a combination of LED spots, spots and wall lights throughout the boat.

## **Gas system**

Fully installed and tested to the relevant standards with storage space for two 13kg propane cylinders either forward or aft depending upon design. All boats come with an independent gas safety certificate.

# External

## **Finishes**

All boats come beautifully coach painted in high gloss marine enamel over high performance primers and undercoats. The standard finish comprises one colour with a contrasting coachline but we are able to accommodate almost all personal preferences when it comes to specifying your chosen colour schemes, from additional colours for the side panels, roof and handrails to traditional decoration such as counter bands and bow panels. A non slip coating is applied to all relevant areas such as decks, roof and gunwhales. The lower hull is prepared and bitumin blacked and has four anodes fitted ready for use in fresh water. (If you intend to keep your boat in salt or brackish water please ask about suitable alternative protection).

The interior woodwork of your boat is finished in a high performance water based, low VOC, clear acrylic finish which is extremely hardwearing, has minimal impact on the natural colour of the timber and is kinder to the environment.

All soft furnishing fabrics are high quality, modern, upholstery weight materials designed specifically for seating and window dressings. There are hundreds of colours and designs to choose from.

Flooring options are chosen to be attractive, practical and hardwearing with a choice of carpeting, vinyls, laminates and solid hardwood. Available in a broad range of colours and designs and in any combination.

## **Windows**

Variety of windows fitted to both sides comprising of 14" port holes and a mix of 18"/36"/42" sized windows.

# Internal

## Lining and wood type

Oak or Ash faced ply with matching hardwood trim can also be complemented with cream painted panels to the upper cabin interior walls and / or a cream painted tongue and groove ceiling all with matching solid hardwood cappings and trim. To ensure both strength and stability, fitted furniture will be constructed from high quality moisture resistant veneered board, again with solid hardwood cappings.

## Galley - Monarch

The apartment sized galley offers contemporary styling combined with mod cons and ample storage alike. Feature hardwood work surfaces are included as standard (walnut or granite options available) with 4-burner full-sized hob, stainless steel oven and separate grill under. The household size stainless sink features a monobloc tap. The galley comes complete with a microwave and a 12v fridge with freezer box.

## Galley - Emperor

The contemporary country style galley comes complete with a with Belfast sink. The galley on the Emperor is U shaped and located to one side of the boat, leaving the opposite side open to accommodate free standing dining furniture, alongside a built in, full height display shelving unit.

## Saloon - Monarch

The saloon area is designed for free standing furniture. A 32" flat screen TV and a radio/CD player is housed, depending on layout, within a floor to ceiling hardwood multi-media centre with storage, or an under gunwhale side unit. A solid fuel stove sits on a tiled base with hardwood surround.

## Saloon - Emperor

The Emperor's saloon has ample space for comfortable domestic sized chairs and sofa and also benefits from the inclusion of a built in dresser unit. The solid fuel stove is set into a feature fireplace incorporating a mantle shelf and a flat screen TV is situated above this.

## Bathroom

The spacious bathroom has mirrored units and a heated towel rail. There is a large corner shower which is fitted with a waterproof panelling system that provides a contemporary and watertight finish. The feature vanity unit has a hand basin resting on a granite (or walnut) worktop to match the galley. The toilet is an electric macerator pump out. All in all this is a room that wouldn't be out of place in a modern day apartment. Additionally the corridor space on the Emperor is enhanced with the fitting of a range of cupboards, providing additional storage and space for the freezer and washing machine space.

## Bedroom

The bedroom has been designed to create an environment of relaxation and both plenty of practical storage. There is a fixed double or king-size with drawers under and overhead cupboard with down lights. There are multiple wardrobe units and their position in relation to the bed varies between the conventional and reverse layout boats. The bow doors are hardwood, ½ glazed, and fully lockable. The second bedroom option allows you to specify a second cabin containing either a double bed, wardrobe and dressing table or a cabin with a single bed, wardrobes and desk / study area. We can often adapt this area to other uses and include such things as bunk beds or a home office. Please discuss your requirements with us and we will do our best to come up with a workable solution.

# Optional extras

## Technical

|  |           |
|--|-----------|
| Vetus 65, 4 cylinder engine with twin alternators.<br>PRM 150 hydraulic gearbox. Engine control panel<br>with tachometer, water temperature, oil pressure &<br>battery warning lights and voltage indicator.<br>RCD emission compliant. 3 year warranty. | £2,495.00 |
| Vetus 95kg/f bow thruster complete, installed  | £3495.00  |
| Victron 3000w combi inverter/charger   | £1495.00  |
| Hospital Silencer  | £ 575.00  |
| Bow tube only  | £ 750.00  |
| Travel power (240v)  | £3250.00  |
| Water and fuel gauges  | £ 495.00  |
| Immersion heater   | £ 145.00  |
| Navigation lights  | £ 395.00  |

## External

|  |          |
|--|----------|
| Bow Lockers (port & starboard)                   | £ 395.00 |
| Chrome pack (windows will be polished aluminium) | £ 395.00 |
| Houdini hatch (each)                             | £ 895.00 |
| Additional side door (each)                      | £ 795.00 |
| Glazed interior side doors (each)                | £ 495.00 |
| Trad/Semi Trad                                   | £1495.00 |
| Toe Steps  | £ 95.00  |
| Cratch and Cover                                 | £2895.00 |

## Internal

|   |               |
|---|---------------|
| Laminate flooring throughout                      | £ 695.00      |
| Solid Oak flooring throughout                     | from £1195.00 |
| Integral Freezer (11ft & 12ft layouts)            | £ 795.00      |
| Second bedroom                                    | £1450.00      |
| 15" TV for bedroom                                | £ 495.00      |
| Additional TV aerial                              | £ 100.00      |
| Cream painted T&G ceiling                         | £ 575.00      |
| Cream painted wall panels to interior cabin sides | £ 650.00      |
| Satellite TV                                      | from £ 945.00 |